

# infinityFracX™

## Intervention-less, Large-Bore Ball-Drop MSHF System

### Technical Specifications

infinityFracX™ is an interventionless, **large bore** stimulation port featuring a **dissolvable ball** rated to 18,000 psi differential working pressure. Graduated seats with **0.010 inch diameter increments between stages** provides port selectivity and overlap for mechanically engaging the balls and opening the sleeves.

### Features

- The IFX sleeve's outer diameters are only 0.200 inches larger than a premium casing coupling.
- A simplified one-piece sleeve housing design facilitates challenging wellbore installations as well as ERD and ultra-ERD applications.
- IFX Sleeves are opened and treated sequentially by dropping balls, starting from the deepest stages and moving to shallower stages as the stages are completed.
- **Up to 264 single point of entry stages or clusters per well with the smallest inner diameter being 2.000 inches.**
- Up to ten clusters per stage for limited entry applications.
- Wear resistant materials integrated with an erosion reducing geometry eliminates missed seating events.
- Balls can be pumped through subsea wellhead assemblies and stimulation vessel coflex reels.
- No flushes required between activation balls and treatment fluids.
- HPHT compatible (350°F, 18,000 psi differential rating).
- The IFX™ stimulation sleeves can be isolated by annulus cement, or open-hole packers.
- Sleeves are permanently locked open with a body lock ring.
- No handling pups required - sleeves can be lifted by hand onto the stump.

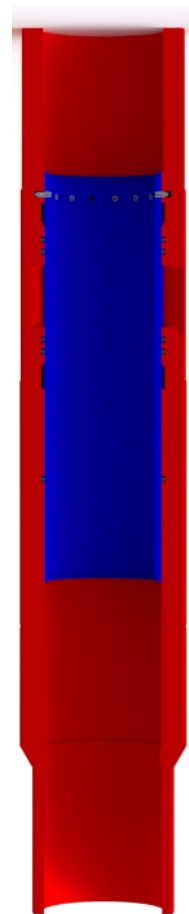

# infinityFracX™

Intervention-less, Large-Bore Ball-Drop MSHF System

Technical Specifications

Tool Nominal Size (inch)	4.500					
Casing Weight (ppf)	11.6		13.5		15.1	
Casing Connection (All Available)	BTC	TXP	BTC	TXP	BTC	TXP
Burst Rating (psi)	15,487	15,021	15,640	16,135	19,655	16,782
Collapse Rating (psi)	14,761	14,336	14,900	15,348	18,500	15,932
Tensile Rating (klbf)	683,327					
Torsional Strength (ft-lbf)	11,846					
Maximum OD (inch)	5.300					
Minimum ID of Largest ID Sleeve (inch)	3.700	3.600	3.700	3.500	3.600	3.400
Loss of ID per Stage Increment (inch)	0.010					
Total Available Stages	170	160	170	150	160	140
Minimum ID of Lower Most Sleeve (inch)	2.000					
Maximum Temperature (°F)	350					
Total Overall Length (inch)	28					
Max Ball Differential Pressure (psi)	18,000					
Opening Pressure (psi)	1500-2000					
Port Flow Area Sizing (inch <sup>2</sup> )	Any					

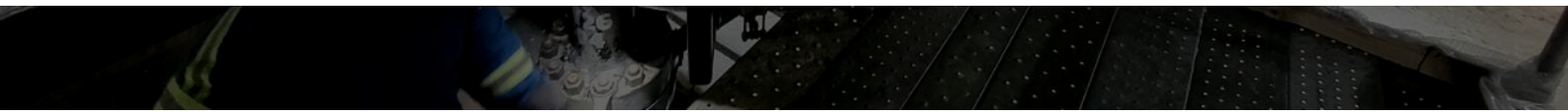

# infinityFracX™

Intervention-less, Large-Bore MSHF System

## Technical Specifications

Tool Nominal Size (inch)	5.000					
Casing Weight (ppf)	13.0		15.0		18.0	
Casing Connection [All Available]	BTC	TXP	BTC	TXP	BTC	TXP
Burst Rating (psi)	16,672	20,184	16,672	14,628	20,102	15,008
Collapse Rating (psi)	15,883	18,967	15,883	13,978	18,892	14,324
Tensile Rating (klbf)	828,100					
Torsional Strength (ft-lbf)	13,894					
Maximum OD (inch)	5.800					
Minimum ID before Stim of Largest ID Sleeve (inch)	4.100	3.900	4.100	4.000	4.000	3.850
Loss of ID per Stage Increment (inch)	0.010					
Total Available Stages	210	190	210	200	200	184
Minimum ID of Lower Most Sleeve (inch)	2.000					
Maximum Temperature (°F)	350					
Total Overall Length (inch)	30					
Max Ball Differential Pressure (psi)	18,000					
Opening Pressure (psi)	1500-2000					
Port Flow Area Sizing (inch <sup>2</sup> )	Any					



# infinityFracX™

Intervention-less, Large-Bore MSHF System

## Technical Specifications

Tool Nominal Size (inch)	5.500							
Casing Weight (ppf)	17.0		20.0		23.0		26.0	
Casing Connection [All Available]	BTC	TXP	BTC	TXP	BTC	TXP	BTC	TXP
Burst Rating (psi)	13,899	10,720	16,635	15,143	19,727	15,225	24,365	18,345
Collapse Rating (psi)	12,984	10,367	15,800	14,828	18,563	14,522	22,614	17,334
Tensile Rating (klbf)	986,273							
Torsional Strength (ft-lbf)	15,843							
Maximum OD (inch)	6.300							
Minimum ID before Stim of Largest ID Sleeve (inch)	4.650	4.550	4.550	4.300	4.450	4.200	4.200	4.000
Loss of ID per Stage Increment (inch)	0.010							
Total Available Stages	264	254	254	230	244	230	230	200
Minimum ID of Lower Most Sleeve (inch)	2.00							
Maximum Temperature (°F)	350							
Total Overall Length (inch)	32							
Max Ball Differential Pressure (psi)	18,000							
Opening Pressure (psi)	750-2500							
Port Flow Area Sizing (inch <sup>2</sup> )	Any							

